

# Working With Lists and Indents in the Whitespace Editor

1.

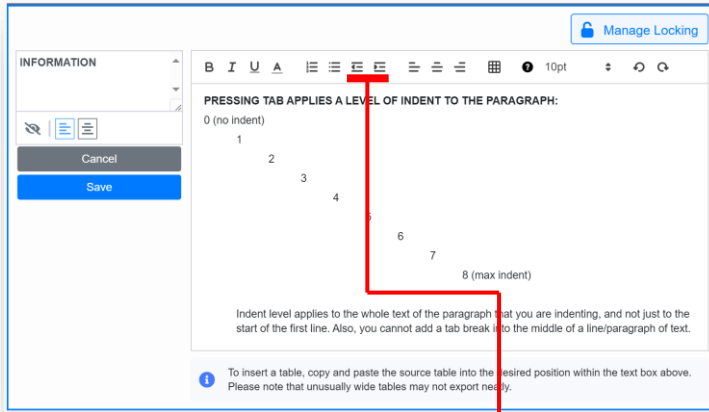

In the Whitespace Platform text editor, tab stops are pre-defined as shown above, and go up to a maximum indent level of 8. Tabs always set the left-hand indent of the paragraph. It's not possible to add a tab stop inside a line of text.

2.

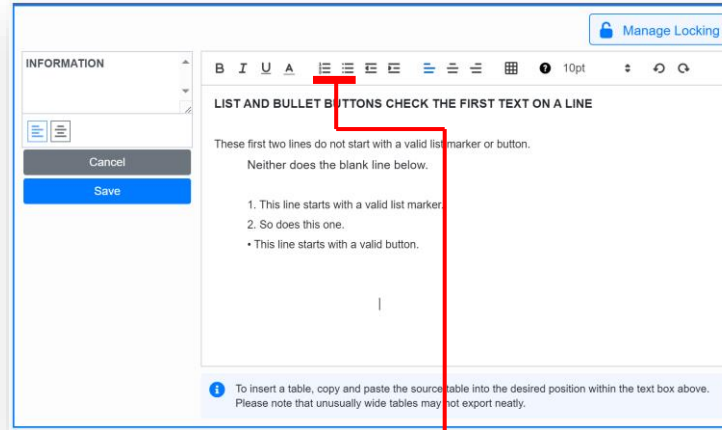

When using automatic numbered and bulleted lists, it is important to understand that the list buttons work differently if the line your cursor is currently on starts with a valid list item marker.

3.

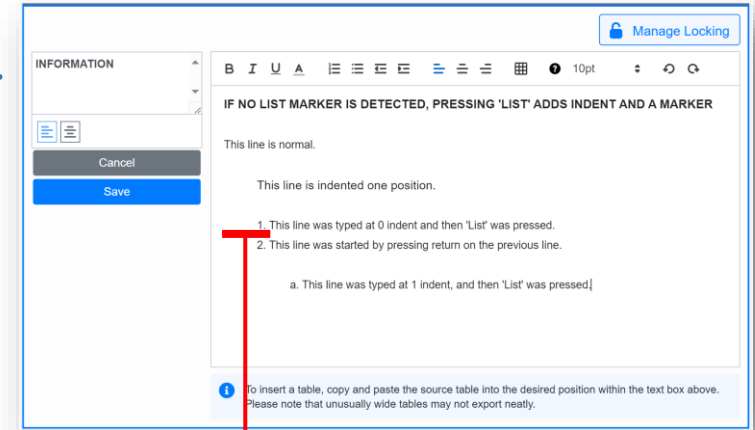

When you press a list button on a line that does **not** start with a list marker, the line is indented one stop, and a list marker is added. This is true at any indent level. Different indent levels have different numbered list markers associated with them.

4.

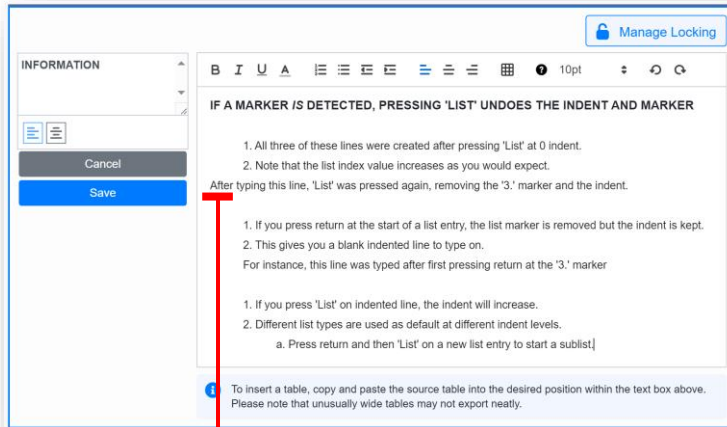

When you press a list button on a line that **does** start with a list marker, the line's indent is decreased by 1, and the list marker is removed. If you press return on a line with a list marker and nothing else, the list marker is removed but the indent remains.

5.

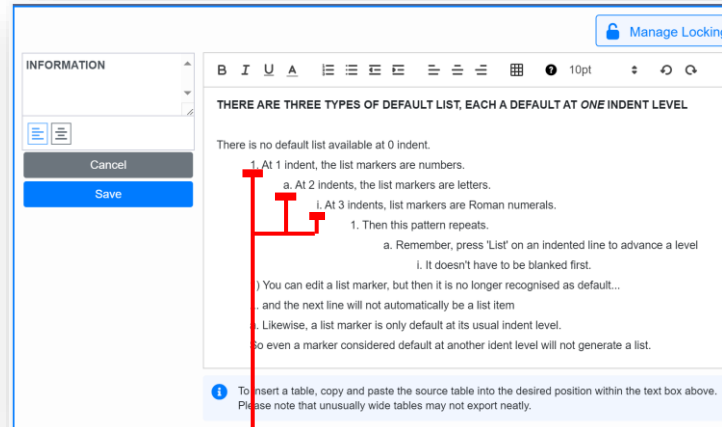

Each indent level has a different automatic numbered list marker, cycling through numbers, letters, and roman numerals. Only the expected list marker for that level will automatically continue the list numbering when you press return.

6.

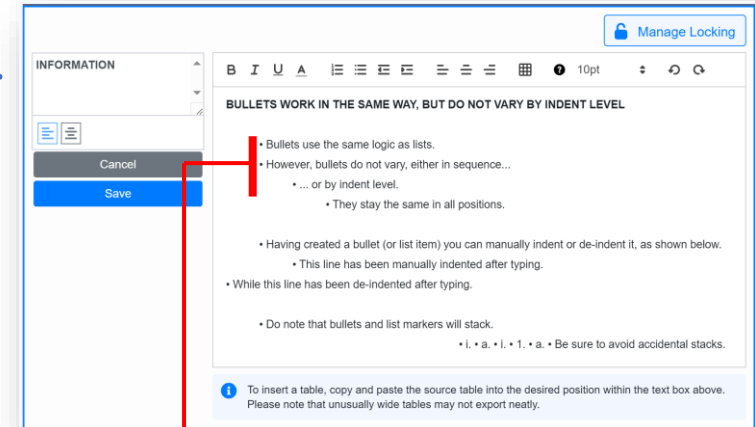

Bullet lists operate on exactly the same logic as numbered lists, except that there is only one bullet character which is the same at all indent levels and list depths. List lines can have their indent increased or decreased after creation. This does not update numbered list markers, but it stops new automatic list items.